



*Sweetwater Environmental Management, LLC*

720 East Landis Avenue, Rear  
Vineland, New Jersey 08360

## **School Potable Water System Lead Testing**

Main Road School  
1452 Main Road  
Newfield, NJ 08344

06/29/2022

Prepared By:  
Frederick J. Gross, REM • CEA • LO  
Sweetwater Environmental Management, LLC

## Drinking Water Outlet Inventory & Results

Name of School: Main Road School      Address: 1452 Main Road, Newfield NJ 08344  
 PWS ID NJ0805308  
 Date Completed: 5/25/2022

#	Outlet Type	Location	Code	Lead Result ug/l	Lead Limit ug/l *	Ma P ID	Comments
1	Water Cooler	North Central Hall	MRS-NCHL-WC-01	N/A	N/A	01	Out-Of-Service, No Sample
2	Sink	Kitchen	MRS-RM26-KC-02	<1	15	02	SAMPLE, Incompliance
3	Sink	Kitchen	MRS-RM26-KC-03	2.2	15	03	SAMPLE, Incompliance
4	Sink	Kitchen	MRS-RM26-HB-04	N/A	N/A	04	Non-Drinking Water Outlet, No Sample
5	Sink	Kitchen	MRS-RM26-DS-05	N/A	N/A	05	Non-Drinking Water Outlet, No Sample
6	Bubbler	North Hall	MRS-NHL-DW-06	N/A	N/A	06	Out-Of-Service, No Sample
7	Sink	North Hall Boy's Room	MRS-NHLB-BS-07	N/A	N/A	07	Non-Drinking Water Outlet, No Sample
8	Sink	North Hall Boy's Room	MRS-NHLB-BS-08	N/A	N/A	08	Non-Drinking Water Outlet, No Sample
9	Sink	North Hall Boy's Room	MRS-NHLB-BS-9	N/A	N/A	09	Non-Drinking Water Outlet, No Sample
10	Sink	North Hall Boy's Room	MRS-NHLB-BS-10	N/A	N/A	10	Non-Drinking Water Outlet, No Sample
11	Sink	North Hall Girl's Room	MRS-NHLG-BS-11	N/A	N/A	11	Non-Drinking Water Outlet, No Sample
12	Sink	North Hall Girl's Room	MRS-NHLG-BS-12	N/A	N/A	12	Non-Drinking Water Outlet, No Sample
13	Sink	North Hall Girl's Room	MRS-NHLG-BS-13	N/A	N/A	13	Non-Drinking Water Outlet, No Sample
14	Sink	North Hall Girl's Room	MRS-NHLG-BS-14	N/A	N/A	14	Non-Drinking Water Outlet, No Sample
15	Bubbler	North West Hall	MRS-NWHL-DW-15	N/A	N/A	15	Out-Of-Service, No Sample
16	Sink	Room 33	MRS-RM33-BS-16	N/A	N/A	16	Non-Drinking Water Outlet, No Sample

\* ug/l = Micrograms per Liter or Parts per Billion

\*\* NJDEP Sample Type / S = Standard, SR = Reduced within Standard pool, A = Alternate, N = Not part of sampling pool

### TABLE KEY

	Sample collected, the result was less than the LEAD Action Limit (15 ug/l), sample is acceptable for potable water.
	Sample collected, the result was greater than the LEAD Action Limit (15 ug/l), outlet was removed and plumbing sealed.
	N/A NO Sample collected, outlet exempted, NOT A DRINKING WATER SOURCE, sanitation only hand wash or equipment sink

#	Outlet Type	Location	Code	Lead Result ug/l	Lead Limit ug/l *	Map ID	Comments
17	Sink	Room 31	MRS-RM31-OC-17	1.8	15	17	SAMPLE, Incompliance
18	Sink	Room 31	MRS-RM31-BS-18	N/A	N/A	18	Non-Drinking Water Outlet, No Sample
19	Water Cooler	South Central Hall	MRS-SCHL-WC-19	N/A	N/A	19	Out-Of-Service, No Sample
20	Sink	Room 10	MRS-RM10-TL-20	1.2	15	20	SAMPLE, Incompliance
21	Sink	Room 11	MRS-RM11-BS-21	N/A	N/A	21	Non-Drinking Water Outlet, No Sample
22	Sink	Room 11	MRS-RM11BS-22	N/A	N/A	22	Non-Drinking Water Outlet, No Sample
23	Bubbler	South East Hall	MRS-SEHL-DW-23	N/A	N/A	23	Out-Of-Service, No Sample
24	Sink	South East Hall Girl's Room	MRS-SEHG-BS-24	N/A	N/A	24	Non-Drinking Water Outlet, No Sample
25	Sink	South East Hall Girl's Room	MRS-SEHG-BS-25	N/A	N/A	25	Non-Drinking Water Outlet, No Sample
26	Sink	South East Hall Girl's Room	MRS-SEHG-BS-26	N/A	N/A	26	Non-Drinking Water Outlet, No Sample
27	Sink	South East Hall Girl's Room	MRS-SEHG-BS-27	N/A	N/A	27	Non-Drinking Water Outlet, No Sample
28	Sink	South East Hall Boy's Room	MRS-SEHB-BS-29	N/A	N/A	29	Non-Drinking Water Outlet, No Sample
29	Sink	South East Hall Boy's Room	MRS-SEHB-BS-30	N/A	N/A	30	Non-Drinking Water Outlet, No Sample
30	Sink	South East Hall Boy's Room	MRS-SEHB-BS-31	N/A	N/A	31	Non-Drinking Water Outlet, No Sample
31	Sink	South East Hall Boy's Room	MRS-SEHB-BS-32	N/A	N/A	32	Non-Drinking Water Outlet, No Sample
32	Bubbler	South Hall	MRS-SHL-DW-33	N/A	N/A	33	Out-Of-Service, No Sample
33	Sink	Nurse's Office	MRS-NURS-NS-34	<1	15	34	SAMPLE, Incompliance
34	Sink	Nurse's Office	MRS-NURS-BS-35	N/A	N/A	35	Non-Drinking Water Outlet, No Sample
35	Sink	Nurse's Office	MRS-NURS-BS-36	N/A	N/A	36	Non-Drinking Water Outlet, No Sample
36	Sink	Nurse's Office	MRS-NURS-BS-37	N/A	N/A	37	Non-Drinking Water Outlet, No Sample
37	Bubbler	South East Hall	MRS-SEHL-DW-38	N/A	N/A	38	Out-Of-Service, No Sample
38	Sink	Room 13	MRS-RM13-AS-39	N/A	N/A	39	Non-Drinking Water Outlet, No Sample
39	Water Cooler	South East Hall	MRS-SEHL-WC-40	N/A	N/A	40	Out-Of-Service, No Sample

\* ug/l = Micrograms per Liter or Parts per Billion

\*\* NJDEP Sample Type / S = Standard, SR = Reduced within Standard pool, A = Alternate, N = Not part of sampling pool

### TABLE KEY

	Sample collected, the result was less than the LEAD Action Limit (15 ug/l), sample is acceptable for potable water.
	Sample collected, the result was greater than the LEAD Action Limit (15 ug/l), outlet was removed and plumbing sealed.
N/A	NO Sample collected, outlet exempted, NOT A DRINKING WATER SOURCE, sanitation only hand wash or equipment sink

#	Outlet Type	Location	Code	Lead Result ug/l	Lead Limit ug/l *	Map ID	Comments
40	Sink	East Hall Boy's Room	MRS-EHLB-BS-41	N/A	N/A	41	Non-Drinking Water Outlet, No Sample
41	Sink	East Hall Boy's Room	MRS-EHLB-BS-42	N/A	N/A	42	Non-Drinking Water Outlet, No Sample
42	Sink	East Hall Boy's Room	MRS-EHLG-BS-43	N/A	N/A	43	Non-Drinking Water Outlet, No Sample
43	Water Cooler	East Hall	MRS-ESHL-WC-44	N/A	N/A	44	Out-Of-Service, No Sample
44	Water Cooler	East Hall	MRS-ESHL-WC-45	N/A	N/A	45	Out-Of-Service, No Sample
45	Sink	East Hall Girl's Room	MRS-EHLG-BS-46	N/A	N/A	46	Non-Drinking Water Outlet, No Sample
46	Sink	East Hall Girl's Room	MRS-EHLG-BS-47	N/A	N/A	47	Non-Drinking Water Outlet, No Sample
47	Sink	East Hall Girl's Room	MRS-EHLG-BS-48	N/A	N/A	48	Non-Drinking Water Outlet, No Sample
48	Sink	Room 61	MRS-RM61-BS-49	<1	15	49	SAMPLE, Incompliance

\* ug/l = Micrograms per Liter or Parts per Billion

\*\* NJDEP Sample Type / S = Standard, SR = Reduced within Standard pool, A = Alternate, N = Not part of sampling pool

#### TABLE KEY

	Sample collected, the result was less than the LEAD Action Limit (15 ug/l), sample is acceptable for potable water.
	Sample collected, the result was greater than the LEAD Action Limit (15 ug/l), outlet was removed and plumbing sealed.
N/A	NO Sample collected, outlet exempted, NOT A DRINKING WATER SOURCE, sanitation only hand wash or equipment sink





**SWEETWATER**  
ENVIRONMENTAL  
MANAGEMENT, LLC

720 East Landis Avenue, Rear  
Vineland, NJ 08360  
Phone: (856) 205-1999  
Fax: (856) 205-1825



CONDUCK  
FLOOR PLAN  
5,924 SQ. FT.  
59,400 SQ. FT.

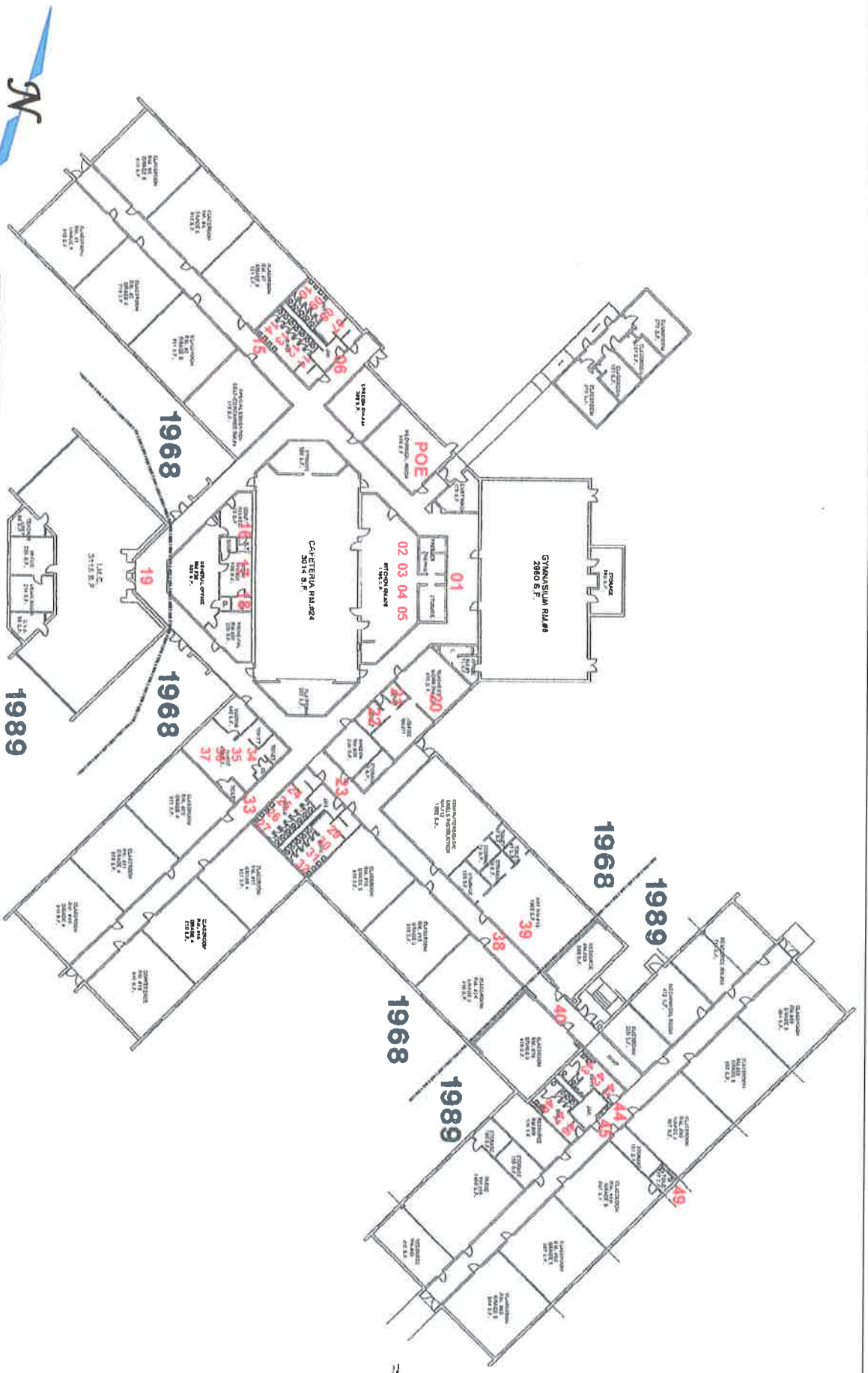

**Potable Water Inventory / Lead Sampling Map**

**Main Road School**  
1452 Main Road  
Newfield, NJ 08344

DRAWN BY	FJG
FILE	FBE
DATE	06/30/2017
SCALE	NTS

PREPARED FOR:  
Franklin Township Board of Education